



Vicarage Farm Road, Hounslow, TW3 4NW

£310,000

A two bedroom first floor apartment. The property is situated within minutes walk from Hounslow West tube station, local shops and restaurants, easy access to Heathrow Airport, M4 motorway and the A4 to Central London. The accommodation comprises open plan kitchen/lounge, two bedrooms and family bathroom. The property also benefits from double glazed windows, electric heating, private garden area and private parking. An ideal first time purchase or investment opportunity. Plans are available for a further two bedrooms, please call now for more information.

A partner of
The Guild Of Professional Estate Agents
with a network of over 700 independent estate agents

Associated Office: 121 Park Lane, Mayfair, London W1K 7AG t 020 7318 7075

Lounge

Kitchen

Bedroom

Shower Room

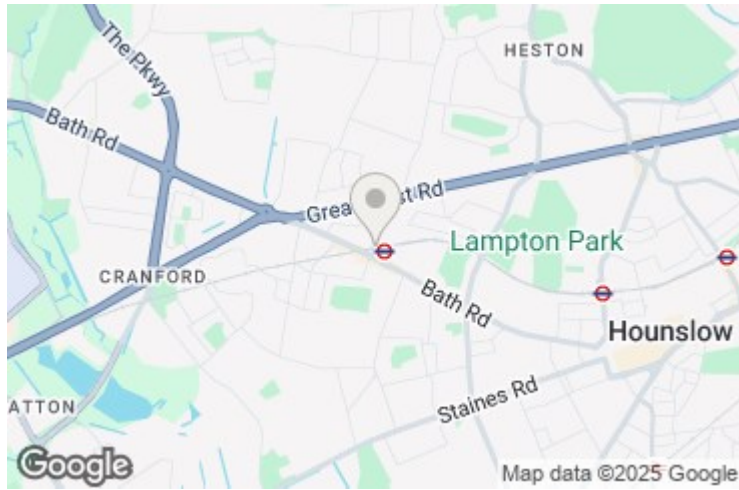

Flat 2 Vicarage Farm Rd, Hounslow TW3 4NW

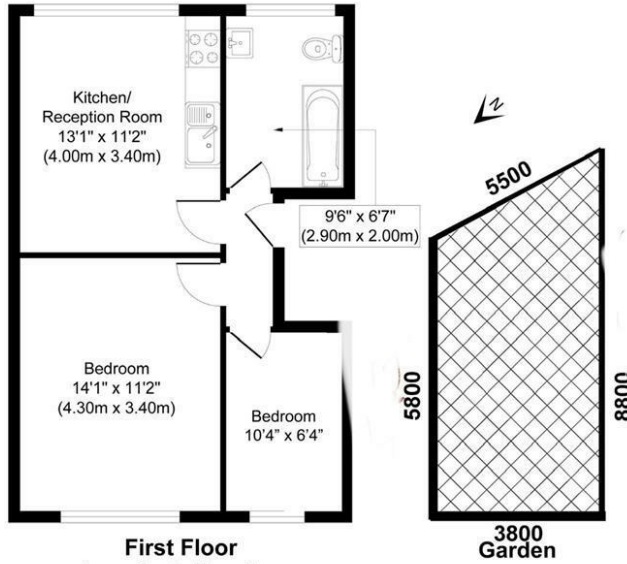

Approx. Gross Internal Floor Area 454.02 sq. ft / 42.18 sq. m
 Illustration for identification purposes only, measurements are approximate, not to scale
 Produced by Instagram: RJORA.PHOTOGRAPHY

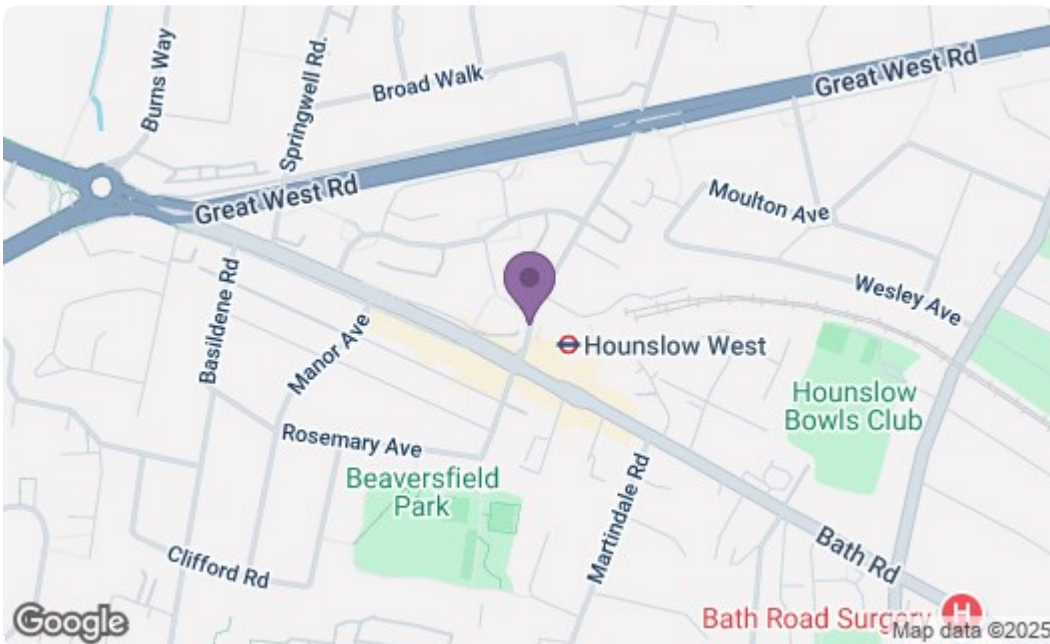

Energy Efficiency Rating		Current	Potential
Very energy efficient - lower running costs			
(92 plus) A			77
(81-91) B			
(69-80) C		66	
(55-68) D			
(39-54) E			
(21-38) F			
(1-20) G			
Not energy efficient - higher running costs			
England & Wales		EU Directive 2002/91/EC	
Environmental Impact (CO ₂) Rating		Current	Potential
Very environmentally friendly - lower CO ₂ emissions			
(92 plus) A			70
(81-91) B			
(69-80) C		61	
(55-68) D			
(39-54) E			
(21-38) F			
(1-20) G			
Not environmentally friendly - higher CO ₂ emissions			
England & Wales		EU Directive 2002/91/EC	

A partner of
The Guild Of Professional Estate Agents
 with a network of over 700 independent estate agents

Associated Office: 121 Park Lane, Mayfair, London W1K 7AG t 020 7318 7075